Submersible Wastewater Pump with Anti-Clog Technology



Model DKE(X)U
Model DDKE(X)U



Technical Information

Technical Information

Impeller Data - DKE(X)U (2 to 30hp)

Model	Power		Type	Design	# Vanes	Back P.O. Vanes
	HP	kW				
50DKE(X)U461.5	2	1.5	Semi-Open	Radial	Single	Yes
80DKE(X)U461.5			Semi-Open	Radial	Single	Yes
80DKE(X)U462.2	3	2.2	Semi-Open	Radial	Single	Yes
100DKE(X)U462.2			Semi-Open	Radial	Single	Yes
80DKE(X)U463.7	5	3.7	Semi-Open	Radial	Single	Yes
100DKE(X)U463.7			Semi-Open	Radial	Single	Yes
80DKE(X)U465.5	7.5	5.5	Semi-Open	Radial	Single	Yes
100DKEB(X)U465.5			Semi-Open	Radial	Single	Yes
100DKE(X)U465.5			Semi-Open	Radial	Double	Yes
80DKE(X)U467.5	10	7.5	Semi-Open	Radial	Double	Yes
100DKEB(X)U467.5			Semi-Open	Radial	Double	Yes
100DKE(X)U467.5			Semi-Open	Radial	Double	Yes
150DKE(X)U467.5			Semi-Open	Radial	Double	Yes
80DKE(X)U4611	15	11	Semi-Open	Radial	Double	Yes
100DKEB(X)U4611			Semi-Open	Radial	Double	Yes
100DKE(X)U4611			Semi-Open	Radial	Double	Yes
150DKE(X)U4611			Semi-Open	Radial	Double	Yes
200DKE(X)U4611			Semi-Open	Radial	Double	Yes
100DKEB(X)U4615	20	15	Semi-Open	Radial	Double	Yes
100DKE(X)U4615			Semi-Open	Radial	Double	Yes
150DKE(X)U4615			Semi-Open	Radial	Double	Yes
200DKE(X)U4615			Semi-Open	Radial	Double	Yes
100DKEB(X)U4618	25	18.5	Semi-Open	Radial	Double	Yes
100DKE(X)U4618			Semi-Open	Radial	Double	Yes
150DKE(X)U4618			Semi-Open	Radial	Double	Yes
200DKE(X)U4618			Semi-Open	Radial	Double	Yes
250DKE(X)U4618			Semi-Open	Radial	Double	Yes
100DKEB(X)U4622	30	22	Semi-Open	Radial	Double	Yes
100DKE(X)U4622			Semi-Open	Radial	Double	Yes
150DKE(X)U4622			Semi-Open	Radial	Double	Yes
200DKE(X)U4622			Semi-Open	Radial	Double	Yes
250DKE(X)U4622			Semi-Open	Radial	Double	Yes



Technical Information

Impeller Data - DKE(X)U (40 to 60hp)

Model	Power		Type	Design	# Vanes	Back P.O. Vanes
	HP	kW				
100DKE(X)U4630	40	30	Semi-Open	Radial	Double	Yes
150DKEB(X)U4630			Semi-Open	Radial	Double	Yes
150DKE(X)U4630			Semi-Open	Radial	Double	Yes
200DKE(X)U4630			Semi-Open	Radial	Double	Yes
250DKE(X)U4630			Semi-Open	Radial	Double	Yes
100DKE(X)U4637	50	37	Semi-Open	Radial	Double	Yes
150DKEB(X)U4637			Semi-Open	Radial	Double	Yes
150DKE(X)U4637			Semi-Open	Radial	Double	Yes
200DKE(X)U4637			Semi-Open	Radial	Double	Yes
250DKE(X)U4637			Semi-Open	Radial	Double	Yes
100DKE(X)U4645	60	45	Semi-Open	Radial	Double	Yes
150DKEB(X)U4645			Semi-Open	Radial	Double	Yes
150DKE(X)U4645			Semi-Open	Radial	Double	Yes
200DKE(X)U4645			Semi-Open	Radial	Double	Yes
250DKE(X)U4645			Semi-Open	Radial	Double	Yes



Technical Information

Impeller Data - DDKE(X)U

Model	Power		Type	Design	# Vanes	Back P.O. Vanes
	HP	kW				
100DDKE(X)U465.5	7.5	5.5	Semi-Open	Radial	Double	Yes
100DDKE(X)U467.5	10	7.5	Semi-Open	Radial	Double	Yes
150DDKE(X)U467.5			Semi-Open	Radial	Double	Yes
100DDKEB(X)U4611	15	11	Semi-Open	Radial	Double	Yes
100DDKEB(X)U4611			Semi-Open	Radial	Double	Yes
150DDKE(X)U4611			Semi-Open	Radial	Double	Yes
100DDKEB(X)U4615	20	15	Semi-Open	Radial	Double	Yes
100DDKE(X)U4615			Semi-Open	Radial	Double	Yes
150DDKE(X)U4615			Semi-Open	Radial	Double	Yes
100DDKEB(X)U4618	25	18.5	Semi-Open	Radial	Double	Yes
100DDKE(X)U4618			Semi-Open	Radial	Double	Yes
150DDKE(X)U4618			Semi-Open	Radial	Double	Yes
100DDKEB(X)U4622	30	22	Semi-Open	Radial	Double	Yes
100DDKE(X)U4622			Semi-Open	Radial	Double	Yes
150DDKE(X)U4622			Semi-Open	Radial	Double	Yes
100DDKE(X)U4630	40	30	Semi-Open	Radial	Double	Yes
150DDKEB(X)U4630			Semi-Open	Radial	Double	Yes
150DDKE(X)U4630			Semi-Open	Radial	Double	Yes
200DDKE(X)U4630			Semi-Open	Radial	Double	Yes
250DDKE(X)U4630			Semi-Open	Radial	Double	Yes
100DDKE(X)U4637	50	37	Semi-Open	Radial	Double	Yes
150DDKEB(X)U4637			Semi-Open	Radial	Double	Yes
150DDKEB(X)U4637			Semi-Open	Radial	Double	Yes
200DDKE(X)U4637			Semi-Open	Radial	Double	Yes
250DDKE(X)U4637			Semi-Open	Radial	Double	Yes
100DDKE(X)U4645	60	45	Semi-Open	Radial	Double	Yes
150DDKEB(X)U4645			Semi-Open	Radial	Double	Yes
150DDKE(X)U4645			Semi-Open	Radial	Double	Yes
200DDKE(X)U4645			Semi-Open	Radial	Double	Yes
250DDKE(X)U4645			Semi-Open	Radial	Double	Yes



Technical Information

Mechanical Seal and Ball Bearing Data - DKE(X)U Non-ICS model

Model	Diam	Power		Ball Bearing		Mech. Seal Model	Capacity		Mechanical Seal Lubricant
		HP	kW	Bottom	Top		OZS	Liters	
50DKE(X)U461.5	50	2	1.5	6306ZZ	6204ZZ	D-25	37	1.1	Turbine Oil #32
80DKE(X)U461.5	80								
80DKE(X)U462.2	80	3	2.2	5307ZZ	6205ZZ	D-30	44	1.3	
100DKE(X)U462.2	100								
80DKE(X)U463.7	80	5	3.7	5307ZZ	6205ZZ	D-30	47	1.4	
100DKE(X)U463.7	100						44	1.3	



Technical Information

Mechanical Seal and Ball Bearing Data - DKE(X)U (2 to 30hp)

Model	Diam	Power		Ball Bearing		Mec. Seal Model	Capacity		Mechanical Seal Lubricant
		HP	kW	Bottom	Top		Gallons	Liters	
50DKE(X)U461.5*	50	2	1.5	6306ZZ	6204ZZ	D-25	2.5	9.5	Propylene Glycol (50wt%)
80DKE(X)U461.5*	80						2.5	9.5	
80DKE(X)U462.2*	80	3	2.2	5307ZZ	6205ZZ	D-30	3.0	11.3	
100DKE(X)U462.2*	100						3.0	11.3	
80DKE(X)U463.7*	80	5	3.7	5307ZZ	6205ZZ	D-30	3.1	11.6	
100DKE(X)U463.7*	100						2.9	11.1	
80DKE(X)U465.5	80	7.5	5.5	5309ZZ	6306ZZ	D-50	6.3	24	
100DKEB(X)U465.5	100						6.3	24	
100DKE(X)U465.5	100						6.1	23	
80DKE(X)U467.5	80	10	7.5	5309ZZ	6306ZZ	D-50	6.3	24	
100DKEB(X)U467.5	100						6.3	24	
100DKE(X)U467.5	100						6.1	23	
150DKE(X)U467.5	150						5.8	22	
80DKE(X)U4611	80	15	11	6310ZZDR	6308ZZ	D-50	5.5	21	
100DKEB(X)U4611	100						5.5	21	
100DKE(X)U4611	100						5.0	19	
150DKE(X)U4611	150						5.0	19	
200DKE(X)U4611	200						5.0	19	
100DKEB(X)U4615	100	20	15	6310ZZDR	6308ZZ	D-60	6.3	24	
100DKE(X)U4615	100						6.1	23	
150DKE(X)U4615	150						6.1	23	
200DKE(X)U4615	200						5.8	22	
100DKEB(X)U4618	100	25	18.5	6312ZZDR	6309ZZ	D-60	8.7	33	
100DKE(X)U4618	100						8.7	33	
150DKE(X)U4618	150						8.2	31	
200DKE(X)U4618	200						7.9	30	
250DKE(X)U4618	250						7.9	30	
100DKEB(X)U4622	100	30	22	6312ZZDR	6309ZZ	D-60	9.2	35	
100DKE(X)U4622	100						9.2	35	
150DKE(X)U4622	150						8.7	33	
200DKE(X)U4622	200						8.5	32	
250DKE(X)U4622	250						8.5	32	

* Opt. (ICS)



Technical Information

Mechanical Seal and Ball Bearing Data - DKE(X)U (40 to 60hp)

Model	Diam	Power		Ball Bearing		Mec. Seal Model	Capacity		Mechanical Seal Lubricant
		HP	kW	Bottom	Top		Gallons	Liters	
100DKE(X)U4630	100	40	30	6315ZZDR	6310ZZ	D-75	9.5	36	Propylene Glycol (50wt%)
150DKEB(X)U4630	150						9.5	36	
150DKE(X)U4630	150						9.5	36	
200DKE(X)U4630	200						9.5	36	
250DKE(X)U4630	250						9.5	36	
100DKE(X)U4637	100	50	37	6315ZZDR	6310ZZ	D-75	9.5	36	
150DKEB(X)U4637	150						9.5	36	
150DKE(X)U4637	150						9.5	36	
200DKE(X)U4637	200						9.5	36	
250DKE(X)U4637	250						9.5	36	
100DKE(X)U4645	100	60	45	6315ZZDR	6310ZZ	D-75	10.6	40	
150DKEB(X)U4645	150						10.6	40	
150DKE(X)U4645	150						10.6	40	
200DKE(X)U4645	200						10.6	40	
250DKE(X)U4645	250						9.5	36	



Technical Information

Mechanical Seal and Ball Bearing Data - DDKE(X)U

Model	Diam Suction X Discharge	Power		Ball Bearing		Mec. Seal Model	Capacity		Mechanical Seal Lubricant
		HP	kW	Bottom	Top		Gallons	Liters	
100DDKE(X)U465.5	100x100	7.5	5.5	5309ZZ	6306ZZ	D-50	6.1	23	Propylene Glycol (50wt%)
100DDKE(X)U467.5	100x100	10	7.5	5309ZZ	6306ZZ	D-50	6.1	23	
150DDKE(X)U467.5	200x150						5.8	22	
100DDKE(X)U4611	100x100	15	11	6310ZZDR	6308ZZ	D-50	5.5	21	
100DDKE(X)U4611	100x100						5.0	19	
150DDKE(X)U4611	200x150						5.0	19	
100DDKE(X)U4615	100x100	20	15	6310ZZDR	6308ZZ	D-60	6.3	24	
100DDKE(X)U4615	100x100						6.1	23	
150DDKE(X)U4615	200x150						6.1	23	
100DDKE(X)U4618	100x100	25	18.5	6312ZZDR	6309ZZ	D-60	8.7	33	
100DDKE(X)U4618	100x100						8.7	33	
150DDKE(X)U4618	200x150						8.2	31	
100DDKE(X)U4622	100x100	30	22	6312ZZDR	6309ZZ	D-60	9.2	35	
100DDKE(X)U4622	100x100						9.2	35	
150DDKE(X)U4622	200x150						8.7	33	
100DDKE(X)U4630	150x100	40	30	6315ZZDR	6310ZZ	D-75	9.5	36	
150DDKE(X)U4630	200x150						9.5	36	
150DDKE(X)U4630	200x150						9.5	36	
200DDKE(X)U4630	250x200						9.5	36	
250DDKE(X)U4630	300x250						9.5	36	
100DDKE(X)U4637	150x100	50	37	6315ZZDR	6310ZZ	D-75	9.5	36	
150DDKE(X)U4637	200x150						9.5	36	
150DDKE(X)U4637	200x150						9.5	36	
200DDKE(X)U4637	250x200						9.5	36	
250DDKE(X)U4637	300x250						9.5	36	
100DDKE(X)U4645	150x100	60	45	6315ZZDR	6310ZZ	D-75	10.6	40	
150DDKE(X)U4645	200x150						10.6	40	
150DDKE(X)U4645	200x150						10.6	40	
200DDKE(X)U4645	250x200						10.6	40	
250DDKE(X)U4645	300x250						9.5	36	



Technical Information

Mechanical Seal Sectional View

Double Mechanical seals with the hard seal face materials are provided on all EBARA submersible pumps operated by ZXDL motor.

The double mechanical seal operates within an oil chamber providing long life and friction-free sealing of the motor shaft.

Typical construction and materials are as follows:

Mechanical Seal Models D-25 and D-30

1. Applicable Model:

2-5hp DKE(X)U

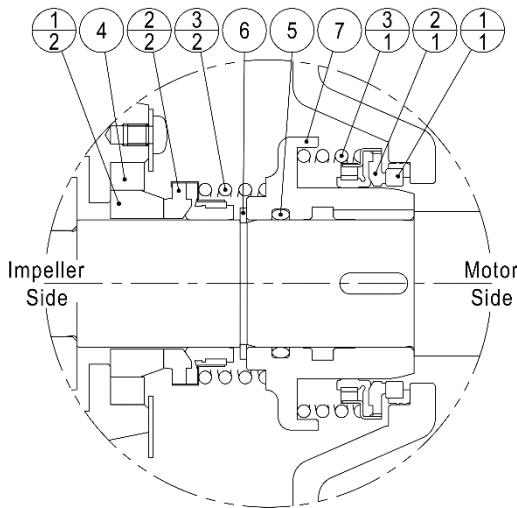

Power		Mec. Seal Model
HP	kW	
2	1.5	D-25
3	2.2	
5	3.7	
7.5	5.5	D-30
10	7.5	
15	11	
20	15	D-50
25	18.5	
30	22	
40	30	D-60
50	37	
60	45	

Item Number	Part Name	Material	Qty per set
1-1	Stationary Mating Ring	Ceramic	1
1-2	Stationary Mating Ring	Silicon Carbide	1
2-1	Rotating Seal Ring	Carbon	1
2-2	Rotating Seal Ring	Silicon Carbide	1
3-1	Spring	Stainless Steel (SUS304)	1
3-2	Spring	Stainless Steel (SUS304)	1
4	Cup Gasket	NBR	1
5	O-ring	NBR	1
6	C-type Snap Ring	Stainless Steel (SUS304)	1
7	Mechanical Seal Sleeve	Stainless Steel (SCS13)	1

2. Applicable Model:

2-5hp ICS Option DKE(X)U

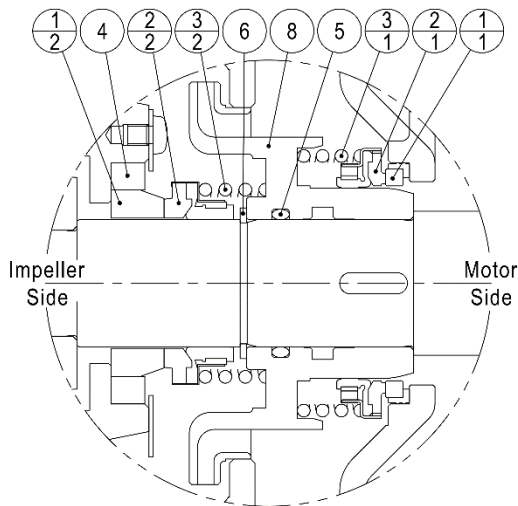

Item Number	Part Name	Material	Qty per set
1-1	Stationary Mating Ring	Ceramic	1
1-2	Stationary Mating Ring	Silicon Carbide	1
2-1	Rotating Seal Ring	Carbon	1
2-2	Rotating Seal Ring	Silicon Carbide	1
3-1	Spring	Stainless Steel (SUS304)	1
3-2	Spring	Stainless Steel (SUS304)	1
4	Cup Gasket	NBR	1
5	O-ring	NBR	1
6	C-type Snap Ring	Stainless Steel (SUS304)	1
8	ICS Impeller	Stainless Steel (SCS13)	1



Technical Information

Mechanical Seal Sectional View

Mechanical Seal Model D-50

3. Applicable Model:

7.5-15hp DKE(X)U / DDKE(X)U

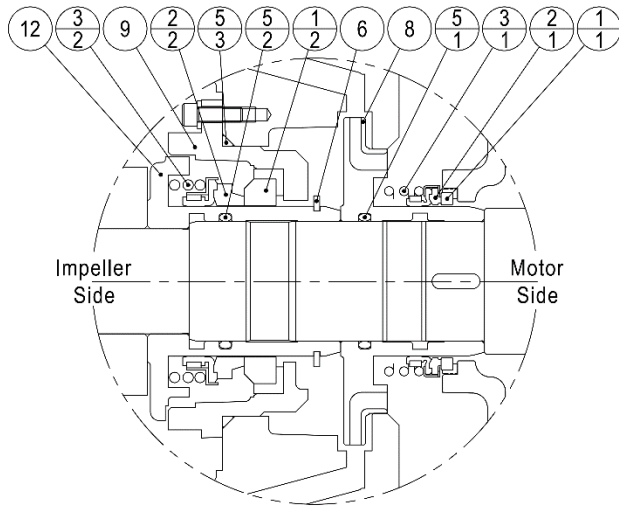

Item Number	Part Name	Material	Qty per set
1-1	Stationary Mating Ring	Ceramic	1
1-2	Stationary Mating Ring	Silicon Carbide	1
2-1	Rotating Seal Ring	Carbon	1
2-2	Rotating Seal Ring	Silicon Carbide	1
3-1	Spring	Stainless Steel (SUS304)	1
3-2	Spring	Stainless Steel (SUS304)	1
5-1	O-ring	NBR	1
5-2	O-ring	NBR	1
5-3	O-ring	NBR	1
6	C-type Snap Ring	Stainless Steel (SUS304)	1
8	ICS Impeller	Stainless Steel (SCS13)	1
9	ICS Housing	FC200	1
12	ICS Sleeve	Stainless Steel (SCS13)	1

Mechanical Seal Model D-60

4. Applicable Model:

20-30hp DKE(X)U / DDKE(X)U

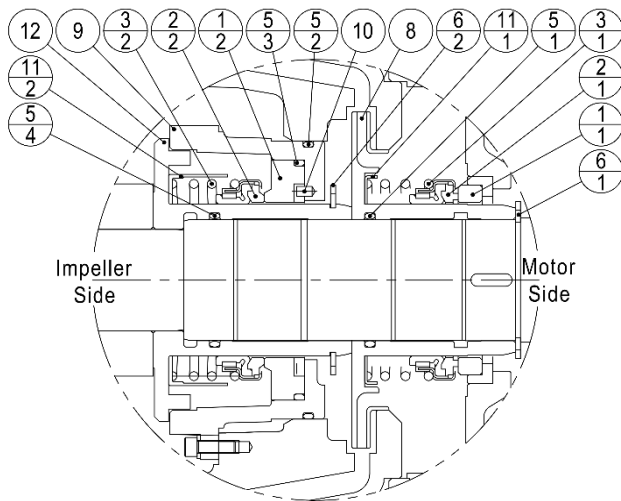

Item Number	Part Name	Material	Qty per set
1-1	Stationary Mating Ring	Ceramic	1
1-2	Stationary Mating Ring	Silicon Carbide	1
2-1	Rotating Seal Ring	Carbon	1
2-2	Rotating Seal Ring	Silicon Carbide	1
3-1	Spring	Stainless Steel (SUS304)	1
3-2	Spring	Stainless Steel (SUS304)	1
5-1	O-ring	NBR	1
5-2	O-ring	NBR	1
5-3	O-ring	NBR	1
5-4	O-ring	NBR	1
6-1	C-type Snap Ring	Stainless Steel (SUS304)	1
6-2	C-type Snap Ring	Stainless Steel (SUS304)	1
8	ICS Impeller	Stainless Steel (SCS13)	1
9	ICS Housing	FC200	1
10	Parallel Pin	Stainless Steel (SUS316)	1
11-1	Spring Holder	Stainless Steel (SUS304)	1
11-2	Spring Holder	Stainless Steel (SUS304)	1
12	ICS Sleeve	Stainless Steel (SCS13)	1

Technical Information

Mechanical Seal Sectional View

Mechanical Seal Model D-75

3. Applicable Model:

40-60hp DKE(X)U / DDKE(X)U

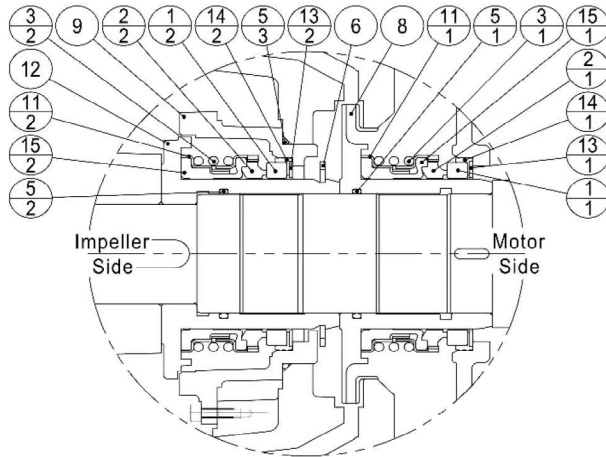

Item Number	Part Name	Material	Qty per set
1-1	Stationary Mating Ring	Ceramic	1
1-2	Stationary Mating Ring	Silicon Carbide	1
2-1	Rotating Seal Ring	Carbon	1
2-2	Rotating Seal Ring	Silicon Carbide	1
3-1	Spring	Stainless Steel (SUS316)	1
3-2	Spring	Stainless Steel (SUS316)	1
5-1	O-ring	NBR	1
5-2	O-ring	NBR	1
5-3	O-ring	NBR	1
6	C-type Snap Ring	Stainless Steel (SUS304)	1
8	ICS Impeller	Stainless Steel (SCS13)	1
9	ICS Housing	FC200	1
11-1	Spring Holder	Stainless Steel (SUS316)	1
11-2	Spring Holder	Stainless Steel (SUS316)	1
12	ICS Sleeve	Stainless Steel (SCS13)	1
13-1	Washer	Stainless Steel (SUS316)	1
13-2	Washer	Stainless Steel (SUS316)	1
14-1	Cup gasket	FKM	1
14-2	Cup gasket	FKM	1
15-1	Bellows	FKM	1
15-2	Bellows	FKM	1

Technical Information

Maximum Submergence

EBARA submersible pumps shall be capable of continuous submergence under water without loss of watertight integrity to the following depths: 65 ft (20m).



Technical Information

Lifting Chain

The EBARA lifting chain is high tensile strength galvanized steel or stainless steel.

Model	Size (A)		Material	Max. Load		Weight		B		Length (C)	
	Inch	mm		lbs	kg	lbs	kg	ft	m	ft	m
LCMG-6	1/4	6	Galvanized Steel	1200	544	12	5.44	2	0.61	20	6.1
LCMS-6	1/4	6	Stainless Steel	1200	544	12	5.44	2	0.61	20	6.1
LCMG-9	3/8	9	Galvanized Steel	2400	1089	24	10.89	3	0.91	20	6.1
LCLS-9	3/8	9	Stainless Steel	2400	1089	24	10.89	3	0.91	20	6.1

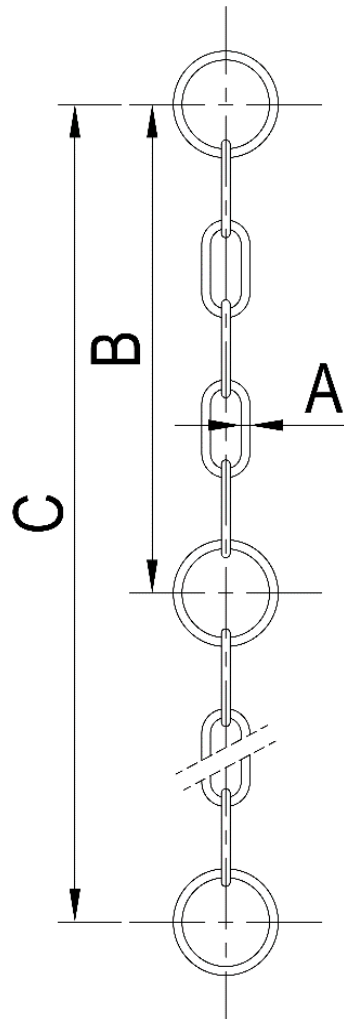

To Attach Chain:

1. Unbolt pump bail
2. Slide open end ring over bail
3. Re-bolt bail to pump top

For chain lengths longer than 20 ft.:
use "quick links" or shackles to join 20ft lengths.



Technical Information

Application of Lifting Chain

Model	Power		Lifting Chain Model	
	HP	kW	Galvanized Steel	Stainless Steel
50DKE(X)U461.5	2	1.5	LCMG-6	LCMS-6
80DKE(X)U461.5			LCMG-6	LCMS-6
80DKE(X)U462.2	3	2.2	LCMG-6	LCMS-6
100DKE(X)U462.2			LCMG-6	LCMS-6
80DKE(X)U463.7	5	3.7	LCMG-6	LCMS-6
100DKE(X)U463.7			LCMG-6	LCMS-6
80DKE(X)U465.5	7.5	5.5	LCMG-6	LCMS-6
100DKEB(X)U465.5			LCMG-6	LCMS-6
100DKE(X)U465.5			LCMG-6	LCMS-6
80DKE(X)U467.5	10	7.5	LCMG-6	LCMS-6
100DKEB(X)U467.5			LCMG-6	LCMS-6
100DKE(X)U467.5			LCMG-6	LCMS-6
150DKE(X)U467.5	15	11	LCMG-6	LCMS-6
80DKE(X)U4611			LCMG-6	LCMS-6
100DKEB(X)U4611			LCMG-6	LCMS-6
100DKE(X)U4611			LCMG-6	LCMS-6
150DKE(X)U4611	20	15	LCMG-6	LCMS-6
200DKE(X)U4611			LCMG-6	LCMS-6
100DKEB(X)U4615			LCMG-6	LCMS-6
100DKE(X)U4615			LCMG-6	LCMS-6
150DKE(X)U4615	25	18.5	LCMG-6	LCMS-6
200DKE(X)U4615			LCMG-9	LCLS-9
100DKEB(X)U4618			LCMG-9	LCLS-9
100DKE(X)U4618			LCMG-9	LCLS-9
150DKE(X)U4618			LCMG-9	LCLS-9
200DKE(X)U4618			LCMG-9	LCLS-9
250DKE(X)U4618			LCMG-9	LCLS-9

Model	Power		Lifting Chain Model	
	HP	kW	Galvanized Steel	Stainless Steel
100DKEB(X)U4622	30	22	LCMG-9	LCLS-9
100DKE(X)U4622			LCMG-9	LCLS-9
150DKE(X)U4622			LCMG-9	LCLS-9
200DKE(X)U4622			LCMG-9	LCLS-9
250DKE(X)U4622			LCMG-9	LCLS-9
100DKE(X)U4630	40	30	LCMG-9	LCLS-9
150DKEB(X)U4630			LCMG-9	LCLS-9
150DKE(X)U4630			LCMG-9	LCLS-9
200DKE(X)U4630			LCMG-9	LCLS-9
250DKE(X)U4630	50	37	LCMG-9	LCLS-9
100DKE(X)U4637			LCMG-9	LCLS-9
150DKEB(X)U4637			LCMG-9	LCLS-9
150DKE(X)U4637			LCMG-9	LCLS-9
200DKE(X)U4637			LCMG-9	LCLS-9
250DKE(X)U4637	60	45	LCMG-9	LCLS-9
100DKE(X)U4645			LCMG-9	LCLS-9
150DKEB(X)U4645			LCMG-9	LCLS-9
150DKE(X)U4645			LCMG-9	LCLS-9
200DKE(X)U4645			LCMG-9	LCLS-9
250DKE(X)U4645			LCMG-9	LCLS-9

Standard Lengths = 20ft (6m)



Technical Information

Shop Painting Standards**1. Applicable Model:**

Model: DKE(X)U / DDKE(X)U

2. Surface Preparation

All surfaces to be painted shall be cleaned of oil, grease or other similar materials with solvent, and then shall be brushed and air blasted to remove rust or scale.

Prior to the above preparation, mill scale, rust scale, chips and other foreign materials shall be removed in accordance with painting schedule.

3. Coating Procedure

Detailed coating procedures are as shown in each paint schedule.

Table-1 Pump part

Service	Painting Schedule			
	Surface Preparation		SSPC-VIS1-3-63	
External Surface	Coats	Type of Coating	Brand Name	Maker
	1st	Zinc-Rich primer	Eco Power Mild 1	KANAE Paint Co., Ltd
	2nd	Coal Tar Epoxy	Hi-Build Tneme-Tar 46-413	Tnemec Co., Inc
Internal Surface	Surface Preparation		SSPC-VIS1-3-63	
	1st	Zinc-Rich primer	Eco Power Mild 1	KANAE Paint Co., Ltd

Table-2 Motor part

Service	Painting Schedule			
	Surface Preparation		SSPC-VIS1-3-63	
External Surface	Coats	Type of Coating	Brand Name	Maker
	1st	Zinc-Rich primer	SD ZINC Primer 100	Kansai Paint Co., Ltd
	2nd	Coal Tar Epoxy	Hi-Build Tneme-Tar 46-413	Tnemec Co., Inc
Internal Surface	Surface Preparation		SSPC-VIS1-3-63	
	1st	Zinc-Rich primer	SD ZINC Primer 100	Kansai Paint Co., Ltd